



# **ANCRA INTERNATIONAL**

**SUZUKI**  
**DUNLOP**  
SUPERIORITY



*Alan R.*

[www.star-cycle.com](http://www.star-cycle.com)

JASON PRIDMORE'S

**STAR  
SCHOOL**



## **Truck and Trailer Restraints and Accessories**

Ankra Series E Track was designed to team with Ancra end fittings, Beams Sockets and Decking and Shoring Beams for the strongest, most reliable support. Steel constructed and tested for strength, Ancra Track comes in 10 ft. (3m) lengths for a wide range of cargo resistant applications. To withstand corrosion, Ancra galvanized track has a G-90 hot dip finish with high-quality, semi-gloss enamel. Custom lengths and special finishes available, contact customer service.

**WARNING:** Reference TTMA RP No. 47-99 for installation. Attach track using screws, rivets or by welding. Contact vehicle manufacturer or qualified installer to determine fastener size and mounting method. Welding or galvanized material may emit toxic fumes. Please use caution and proper ventilation.

**SERIES E** - Series E track is made of high strength 12-gauge steel for Series E end fittings, Beam Sockets and Decking/Shoring Beams. These tracks may be attached with screws, rivets, or by welding.\*

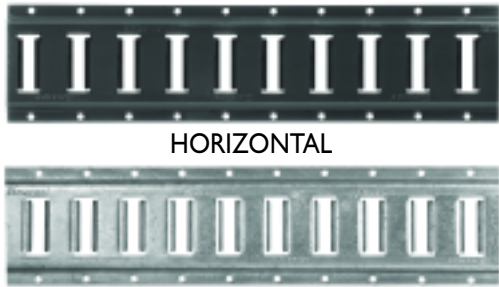

HORIZONTAL

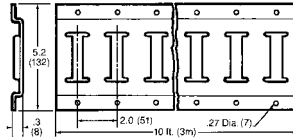

**Part No. 48117-25-120.00**  
 GREEN ENAMEL PAINT  
 Weight/Length: 16.6 lbs./10 ft.  
 7.5 kg./3m  
 Strength: 50,000 lbs. minimum yield

**Part No. 48117-21-120.00**  
 GALVANIZED  
 Weight/Length: 17.2 lbs./10 ft.  
 7.5 kg./3m  
 Strength: 50,000 lbs. minimum yield



V  
E  
R  
T  
I  
C  
A  
L

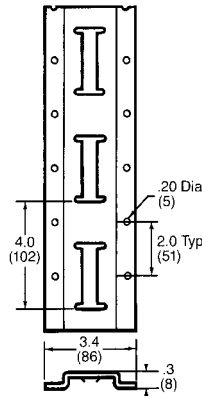

**Part No. 40838-10**  
 GREEN ENAMEL PAINT  
 Weight/Length: 13.5 lbs./10 ft.  
 6.1 kg./3m  
 Strength: 50,000 lbs. minimum yield

**Part No. 40838-11**  
 GALVANIZED  
 Weight/Length: 14 lbs./10 ft./3m  
 Strength: 50,000 lbs. minimum yield

**SERIES E STRAP ASSEMBLY** - 6,000 lb. Polyester Webbing (47200) with Cam Buckle 40880-19 and spring-actuated end fitting



Assembly Breaking Strength Capacity: 2,500 lbs./1,136 kg.  
 Working Load Limit: 833 lbs./378 kg.

**Part No. 40608-21**

**Part No. 40602-17** Length: 12 ft. Weight: 1.90  
**Part No. 40602-18** Length: 16 ft. Weight: 2.10

**SERIES E & A ROPE TIE OFF**



**Part No. 40386-11**  
 Spring actuated fitting for rope use with Series E or Series A Track.  
 Breaking Strength Capacity: 3,000 lbs./1,363 kg.  
 Working Load Limit: 1,000 lbs./454 kg.  
 Weight: 0.40 lb./0.18 kg.

**SERIES E & A ARTICULATED TRACK FITTING**

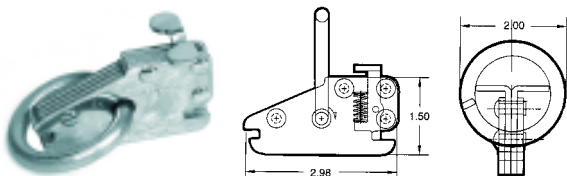

**Part No. 47772-12**  
 Breaking Strength: 3,000 lbs./1,363 kg.  
 Working Load Limit: 1,000 lbs./454 kg.  
 Higher loads achievable in different directions of pull and using stronger track configurations.  
 Weight: 0.45 lb./0.20 kg.

## AIRCRAFT STYLE SEAT/LOGISTIC TRACK



**Part No. 40467-33-144**  
12' long  
Weight: 6.30 lbs./2.86 kg.

Single Stud/Vertical  
Breaking Strength: 4,000 lbs./1,818 kg.  
Working Load Limit: 1,333 lbs./605 kg.

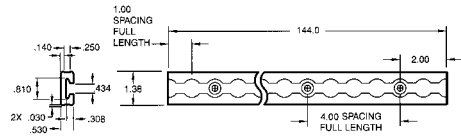

Double Stud/Vertical  
Breaking Strength: 8,500 lbs./3,868 kg.  
Working Load Limit: 2,833 lbs./1,287 kg.

## DOUBLE STUD TRACK FITTING

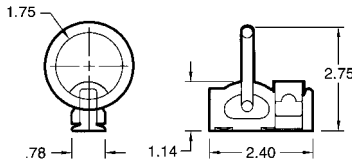

**Part No. 47556-11**  
Breaking Strength: 5,000 lbs./2,272 kg.  
Working Load Limit: 1,666 lbs./757 kg.  
Weight: 0.35 lb./0.16 kg.

## SINGLE STUD TRACK FITTING



**Part No. 40340-20**

- For use in Aircraft Style logistic track or fitting kit anchor plate
- 4,000 lbs. Breaking strength\*
- 1,333 lbs. Working Load Limit

\* Load rating varies with angle of pull

## BOLT-ON FITTING KIT Part No. 40890-10



Quick disconnect fitting kit, ideal for truck, trailer or van.

- Anchor Plate - machined from aluminum extrusion
- Backing Plate - to add support to truck and van beds and walls

- Fitting - Aircraft quality single stud fitting with ring
- Minimum assembly strength - 2,000 lbs. horizontal pull, 4,000 lbs. vertical pull
- Working Load Limit: 650 lbs. horizontal pull, 1,300 lbs. vertical pull

## PAN FITTINGS

Ancra Pan Fittings are designed for low-profile mounting in trucks and trailers. A Recessed Floor Fitting is available for heavy-duty applications. Made from high quality corrosion-resistant material and zinc-plated steel, they feature a special tension feature that reduces the movement of the ring while allowing for easy ring access.



**Part No. 45545-15**  
WITH BLACK TRIM COLLAR  
Breaking Strength: 1,600 lbs./727 kg.  
Working Load Limit: 530 lbs./240 kg.  
Weight: 0.30 lb./0.14 kg.

**Part No. 45849-13**  
RECESSED PAN FITTING  
Breaking Strength: 5,000 lbs./2,272 kg.  
Working Load Limit: 1,666 lbs./757 kg.  
Weight: 1.20 lb./0.55 kg.

## QWIK HOOK™ Part No. 49512-10



Universal truck bed hook instantly add multiple anchor points to MOST standard pickup truck beds

- Fits all mid to late model standard pickup truck beds without "over-the-rail" bed liners
- Durable Extruded Aluminum construction provides years of rust-free use.
- 1,250 lbs. working load capacity per hook.
- Requires no permanent installation or modification of your truck bed.
- Qwik Hooks™ can be Used with tie-downs, rope, or cargo nets.
- When not in use, clip them to the enclosed carabineer for storage
- Packaged qty. 4

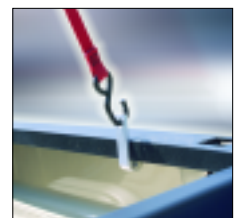
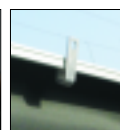



# **ANCRA INTERNATIONAL**

**Ancra International  
Action Sports Products**

**2685 Circleport Drive • Erlanger, KY 41018 • USA**

**Phone: 800-233-5138 • Fax: 800-347-2627**

**[www.ancra.com](http://www.ancra.com)**



Ancra designs and manufactures a full spectrum of restraints and hardware to meet your wide-ranging needs. Our specialty items represent our ongoing mission to provide the right solutions for a changing industry. If you have a particular requirement that calls for a unique solution, give us a call. Our customization capabilities can be your assurance that you have Ancra quality for all your cargo restraint applications.